

SECTION 00 91 10

ADDENDUM NUMBER 1

PARTICULARS

- 1.01 DATE: APRIL 16, 2021**
- 1.02 PROJECT: WILLIAM HOOPER COUNCILL MEMORIAL**
- 1.03 PROJECT NUMBER: B. C. NO. 2021152**
- 1.04 OWNER: ALABAMA A&M UNIVERSITY**
- 1.05 ARCHITECT: NOLA | VAN PEURSEM ARCHITECTS, PC**

TO PROSPECTIVE BIDDERS

- 2.01 THIS ADDENDUM FORMS A PART OF THE CONTRACT DOCUMENTS AND MODIFIES THE BIDDING DOCUMENTS DATED APRIL 9, 2021, WITH AMENDMENTS AND ADDITIONS NOTED BELOW.**
- 2.02 ACKNOWLEDGE RECEIPT OF THIS ADDENDUM IN THE SPACE PROVIDED IN THE PROPOSAL FORM. FAILURE TO DO SO MAY DISQUALIFY THE BIDDER.**
- 2.03 THIS ADDENDUM CONSISTS OF 4 PAGES.**

CHANGES TO THE PROJECT MANUAL (NOT USED)

CHANGES TO THE DRAWINGS

4.01 SHEETS C201 AND C501:

- A. Clarification: 6' tall temporary construction fence to be orange safety fencing on East, West, and South sides of the site. Along north side use 6' tall chain-link temporary panels.

4.02 SHEET A-1.2 – PERGOLA DETAILS:

- A. Wall Section 1/A-1.2: Revise Wall Section per Attachment AD1-A1.2-01.
- B. Add Detail 14/A-1.2 – Wall Section at Eternal Flame per Attachment AD1-A1.2-02.
- C. Add Detail 15/A-1.2 – Wall Section at Monument per Attachment AD1-A1.2-03.

END OF ADDENDUM NUMBER 1

THIS DRAWING MAY NOT BE REPRODUCED IN WHOLE OR IN PART WITHOUT THE CONSENT OF NOLA | VANPEURSEM ARCHITECTS

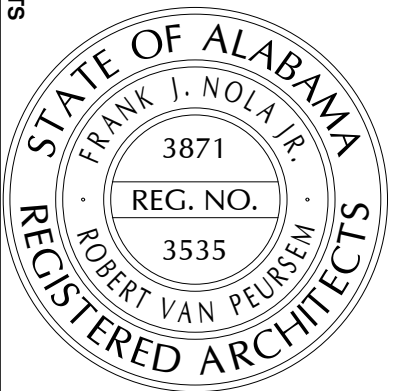
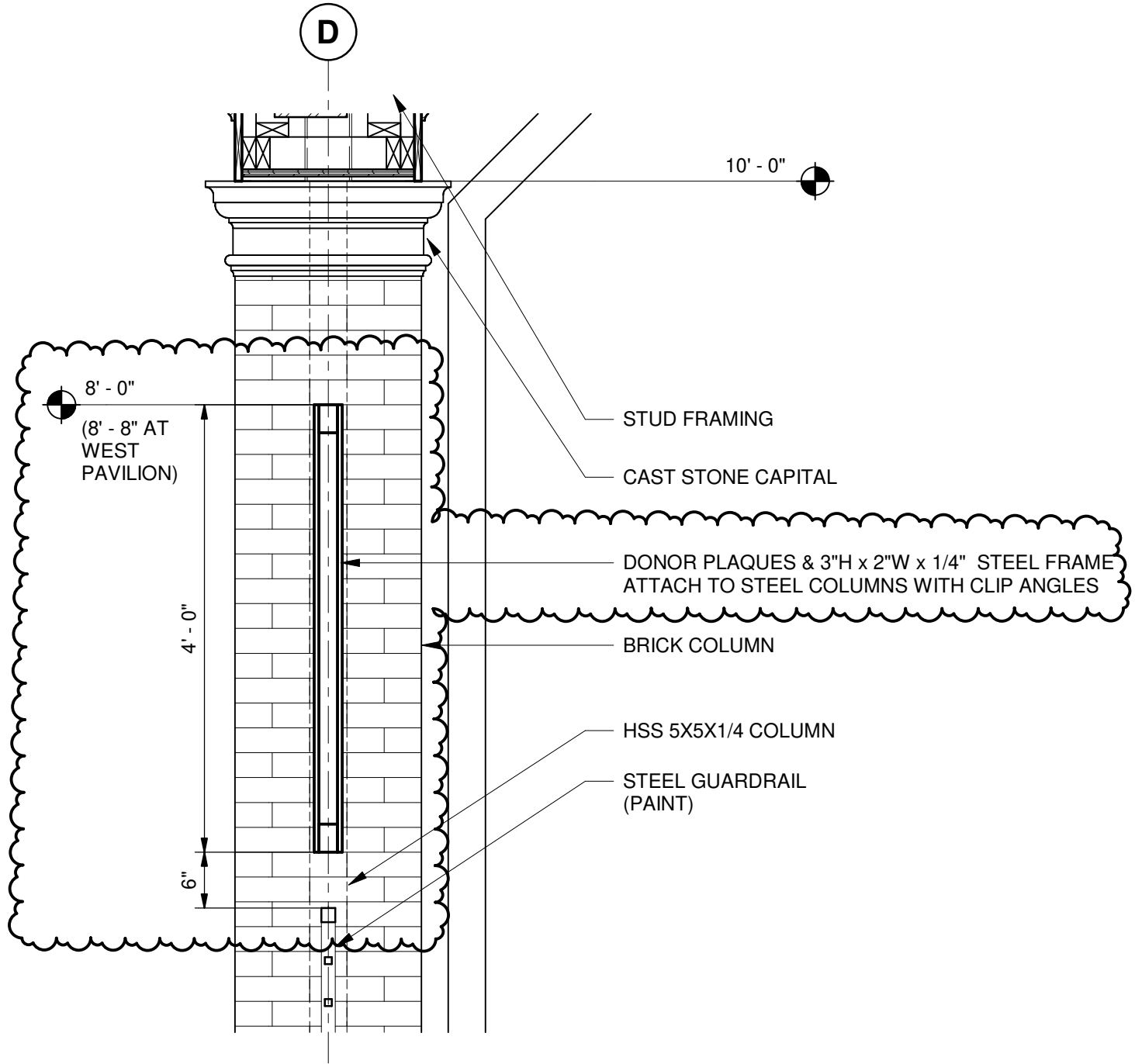

1
A-1.2
3/4" = 1'-0"

WALL SECTION

THIS DRAWING MAY NOT BE REPRODUCED IN WHOLE OR IN PART WITHOUT THE CONSENT OF NOLA | VANPEURSEM ARCHITECTS

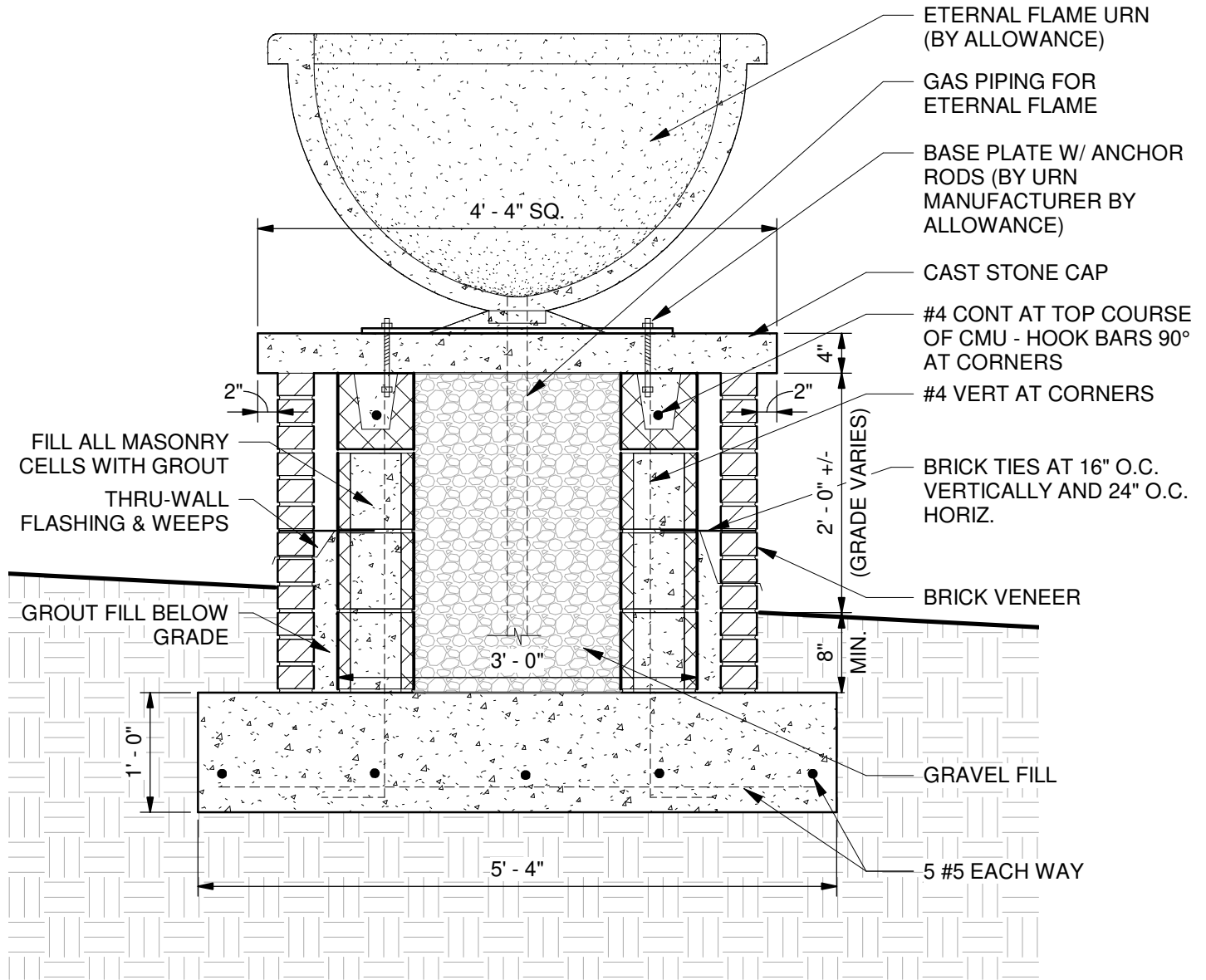

14
A-1.2

WALL SECTION AT ETERNAL FLAME

3/4" = 1'-0"

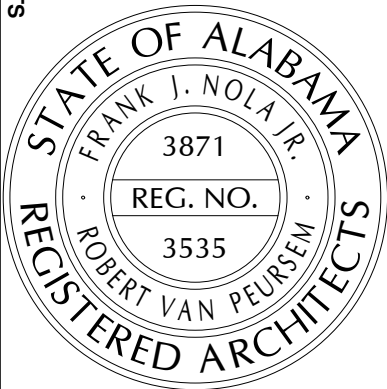

NOLA VANPEURSEM
ARCHITECTS, PC
MEMBER OF THE AMERICAN INSTITUTE OF ARCHITECTS

301 JEFFERSON STREET HUNTSVILLE, ALABAMA 35801 (256) 533-6617 NVPARCHITECTS.COM

ALABAMA A&M UNIVERSITY

WILLIAM HOOPER COUNCILL MEMORIAL

NORMAL, ALABAMA

AD1-A1.2-02

DATE: 04-14-21

THIS DRAWING MAY NOT BE REPRODUCED IN WHOLE OR IN PART WITHOUT THE CONSENT OF NOLA | VANPEURSEM ARCHITECTS

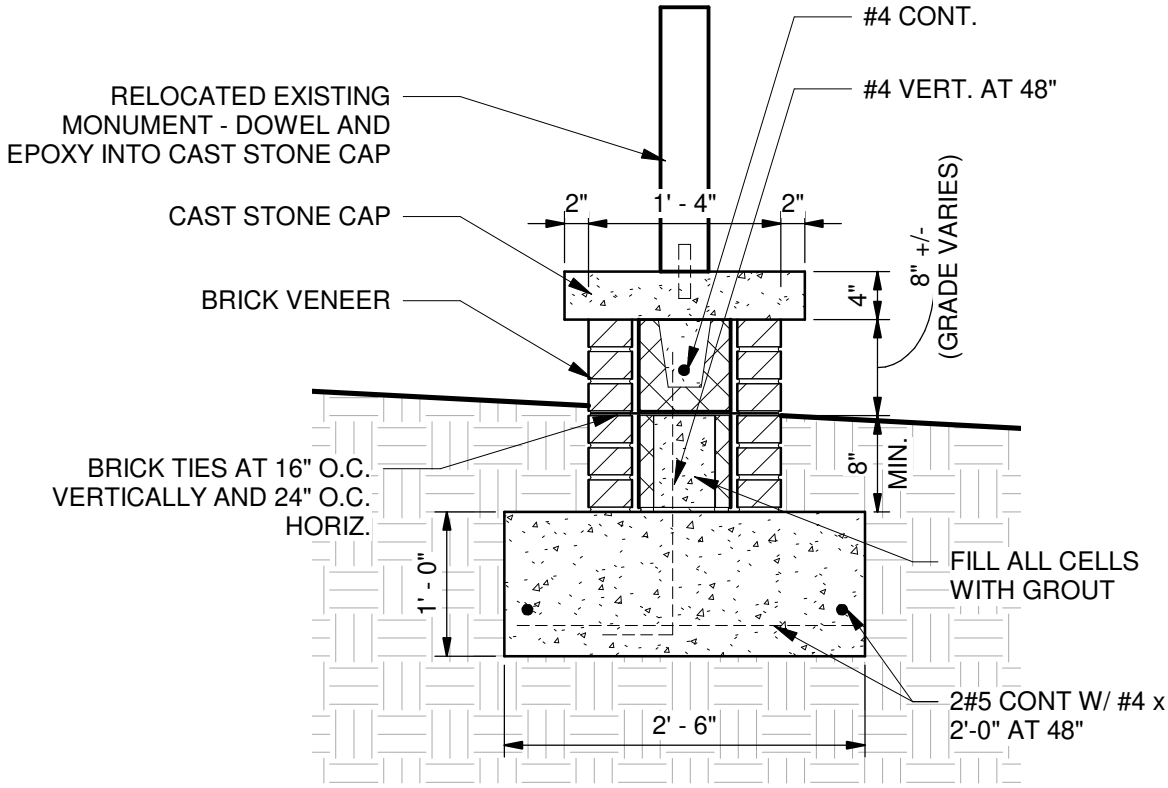

15
A-1.2

WALL SECTION AT MONUMENT

3/4" = 1'-0"

